

STATE OF NORTH CAROLINA
DIVISION OF HIGHWAYS

TRANSPORTATION MANAGEMENT PLAN

POLK COUNTY

LOCATION: BRIDGE 740112 OVER PACOLET RIVER ON EDNEY ROAD
TYPE OF WORK: GRADING, DRAINAGE, PAVING, AND STRUCTURE

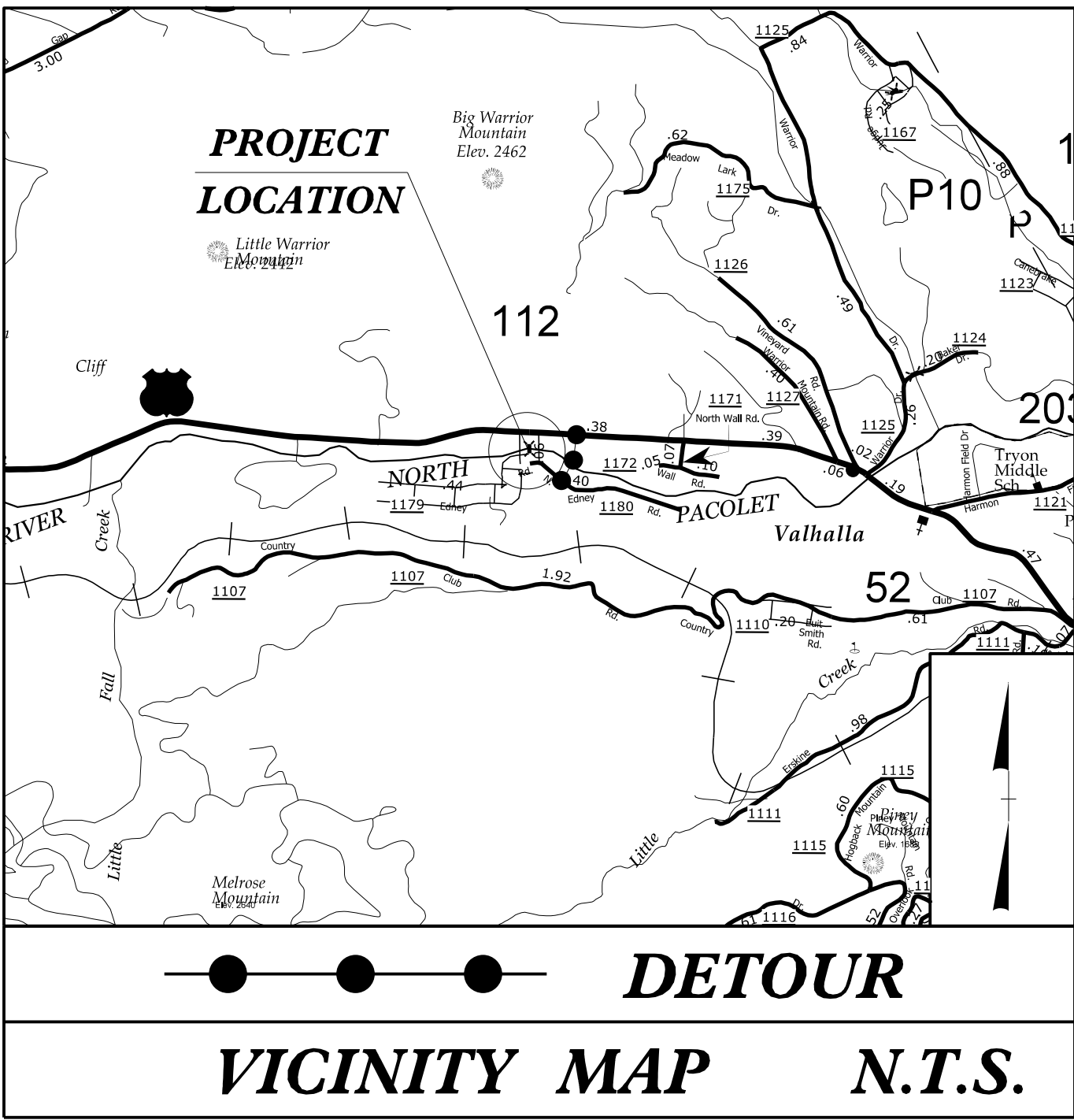
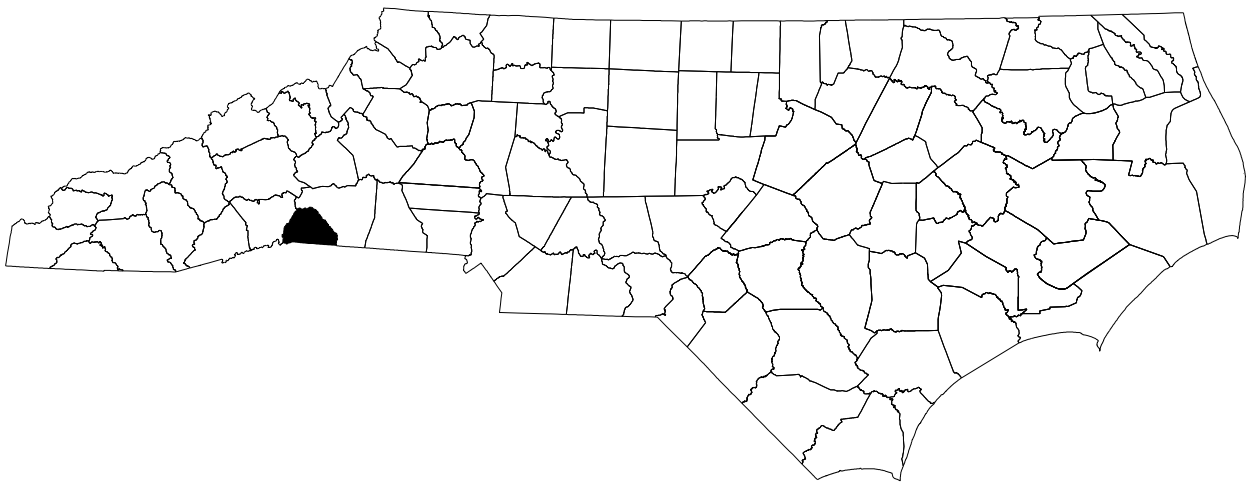

INDEX OF SHEETS

SHEET NO.	TITLE
TMP-1	TITLE SHEET, VICINITY MAP, AND INDEX OF SHEETS
TMP-1A	LIST OF APPLICABLE ROADWAY STANDARD DRAWINGS, MANAGEMENT STRATEGY, AND LEGEND
TMP-2	TRANSPORTATION OPERATIONS PLAN: (GENERAL NOTES)
TMP-2A	EDNEY ROAD DETOUR SIGN DESIGN
TMP-2B	EDNEY ROAD OFF-SITE DETOUR ROUTE
TMP-3	TEMPORARY TRAFFIC CONTROL PHASING

DOCUMENT NOT CONSIDERED FINAL
UNLESS ALL SIGNATURES COMPLETED

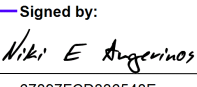
APPROVED: 
DATE: 10/6/2025

RS&H
NC FIRM LICENSE No: F-0493
8521 SIX FORKS ROAD, SUITE 400
RALEIGH, NC 27615

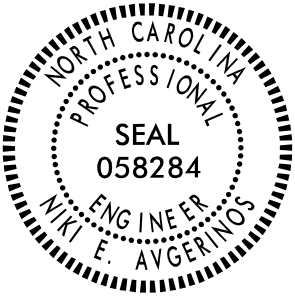

SHEET NO.
TMP-1

T.I.P.: DF18314.2075090

CONTRACT: DN01119

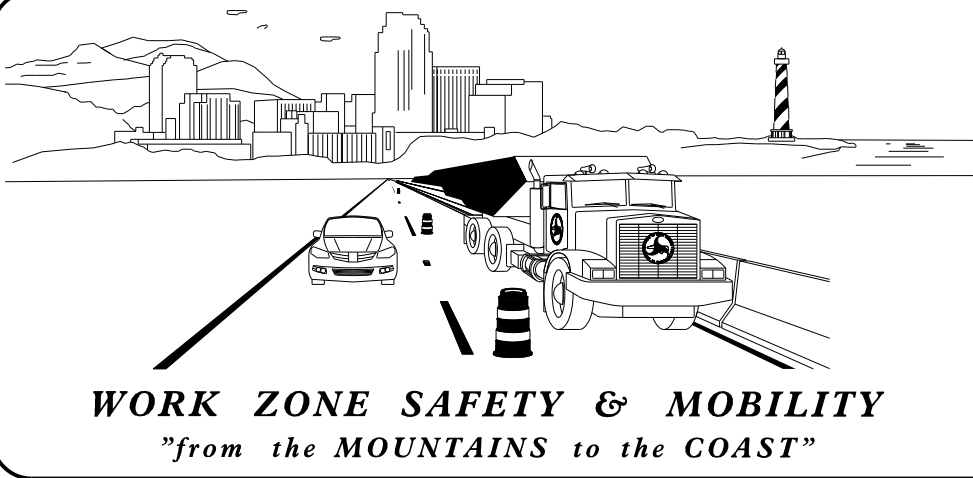

PLANS PREPARED BY:
SEAN KORTOVICH, P.E.
PROJECT ENGINEER
NIKI AVGERINOS, P.E.
PROJECT DESIGN ENGINEER

NCDOT CONTACTS:
ZACHARY SHULER, P.E.
NCDOT PROJECT MANAGER

